

RoHS

版本 REV A0	变更事项 CHANGE CONTENT	依据 THEREUNDER	变更日期 DATE
-----------------	------------------------	------------------	--------------

技术要求:  
Technical requirement  
一. 电气性能:  
electrical performance

- 1-1. 额定电流: 3A AC DC.  
rated current: 3A AC DC.
- 1-2. 接触电阻:  $\leq 20m\Omega$   
Contact resistance:  $\leq 20m\Omega$
- 1-3. 绝缘电阻:  $\geq 1000M\Omega$   
Insulation resistance:  $\geq 1000M\Omega$
- 1-4. 耐压: 550V AC/Minute  
withstand voltage: 550V AC/Minute

二. 物理特性:  
Physical characteristics  
2-1. 环境温度:  $-25^{\circ}C \sim 105^{\circ}C$   
environmental temperature:  $-25^{\circ}C \sim 105^{\circ}C$   
2-2. 焊接温度:  $+260^{\circ}C$ , 10s max  
welding temperature:  $+260^{\circ}C$ , 10s max

- 三. 材质:  
Material
- 3-1. 塑胶: PA6T(Black) UL94V-0  
plastic: PA6T(Black) UL94V-0
  - 3-2. 插针: 黄铜/镀金  
pin: Brass/Gold plated

PIN	A	B
2x2A	5.58	2.54
2x3A	8.12	5.08
2x4A	10.66	7.62
2x5A	13.20	10.16
2x6A	15.74	12.70
2x7A	18.28	15.24
2x8A	20.82	17.78
2x9A	23.36	20.32
2x10A	25.90	22.86
2x11A	28.44	25.40
2x12A	30.98	27.94
2x13A	33.52	30.48
2x14A	36.06	33.02
2x15A	38.60	35.56
2x16A	41.14	38.10
2x17A	43.68	40.64
2x18A	46.22	43.18
2x19A	48.76	45.72
2x20A	51.30	48.26
2x21A	53.84	50.80
2x22A	56.38	53.34
2x23A	58.92	55.88
2x24A	61.46	58.42
2x25A	64.00	60.96
2x26A	66.54	63.50
2x27A	69.08	66.04
2x28A	71.62	68.58
2x29A	74.16	71.12
2x30A	76.70	73.66
2x31A	79.24	76.20
2x32A	81.78	78.74
2x33A	84.32	81.28
2x34A	86.86	83.82
2x35A	89.40	86.36
2x36A	91.94	88.90
2x37A	94.48	91.44
2x38A	97.02	93.98
2x39A	99.56	96.52
2x40A	102.10	99.06

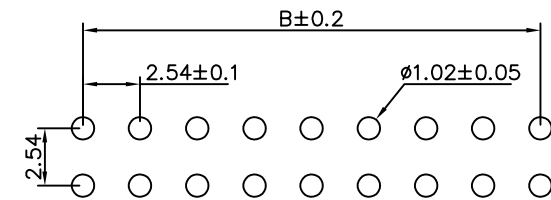
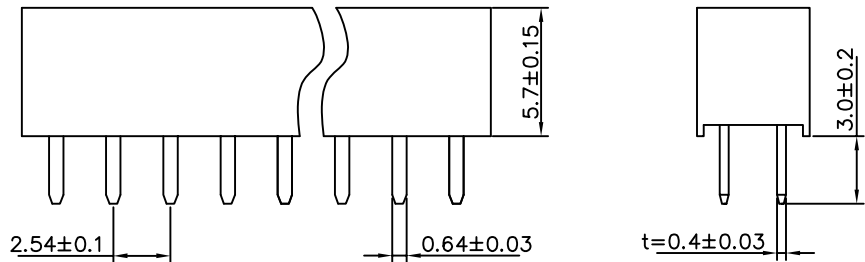
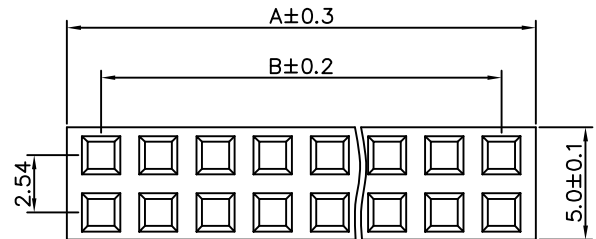

P.C.B LAYOUT

3	包装	<input type="checkbox"/> 袋装 <input type="checkbox"/> 管装 <input type="checkbox"/> 卷装 <input checked="" type="checkbox"/> 盒装	1	PCS
2	塑胶	PH2.54*5.7 Y型 2*nP PA6T料	1	PCS
1	端子	L=7.5 黄铜镀金G/F	/	PCS
ITEM	PART NAME	DESCRIPTION	QUAY	UNIT

		单位 UNIT	mm	泰华电子有限公司 <b>TaiHua Electronics Co., Ltd</b>	
比例 SCALE					
x.±0.5	x.*±	核准:		版本: A0	产品名称 Production name
.x±0.30	.x.*±	APPROVED BY		页次: 1/1	PH2.54*5.7mm 排母 G/F 180度
.xx±0.20	.xx.*±	审核:			产品料号 Product No
.xxx±0.005	.xxx.*±	CHECKED BY		日期:	客户料号 Client No
		制图: 吕灿东 DRAWN BY			